

AREA SUMMARY

LAND AREA = 16ha
 BUILT AREA ON THE LAND = 36602sm
 TOTAL BUILT AREA = 109655sm

CONDOMINIUMS (P+3) - 13269 sqm / 53076 sqm
 CONDOMINIUMS PHASE II - 4505 sqm / 18020 sqm
 SINGLE UNIT HOUSES (P+1) - 7630 sqm / 15260 sqm
 SPORT CENTER - 2303 sqm
 CONFERENCE CENTER - 695 sqm
 HOTEL (P+6) - 1420 sqm / 9940 sqm
 RESTAURANT - 1300 sqm
 RETAIL+CAFETERIA (P+2) - 3881 sqm / 7762 sqm

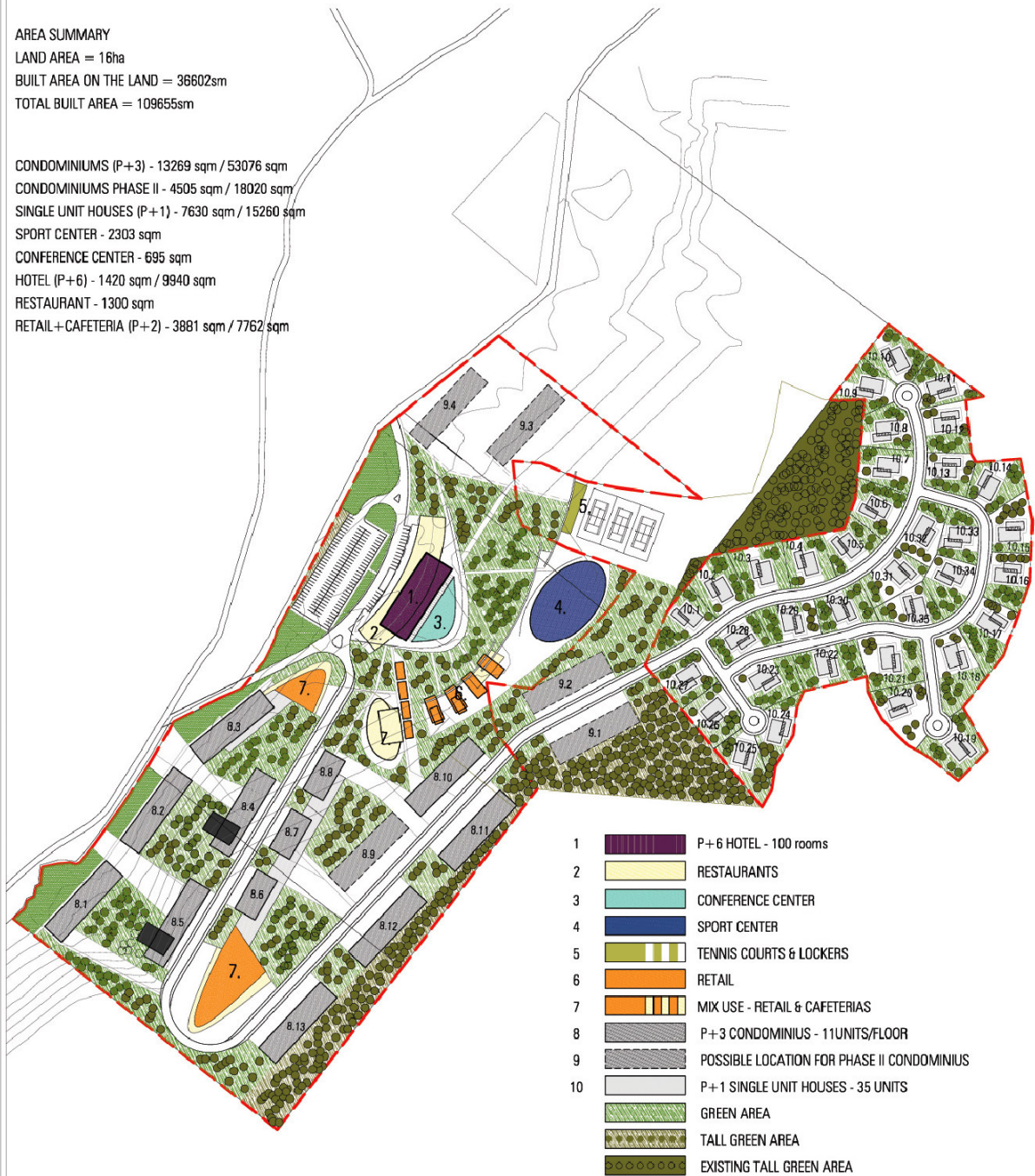

POIANA MICA - RESORT DEVELOPMENT
 SITE PLAN SC 1:2500

